

**FLYWHEEL, IGNITION COIL AND SWITCH BOX**

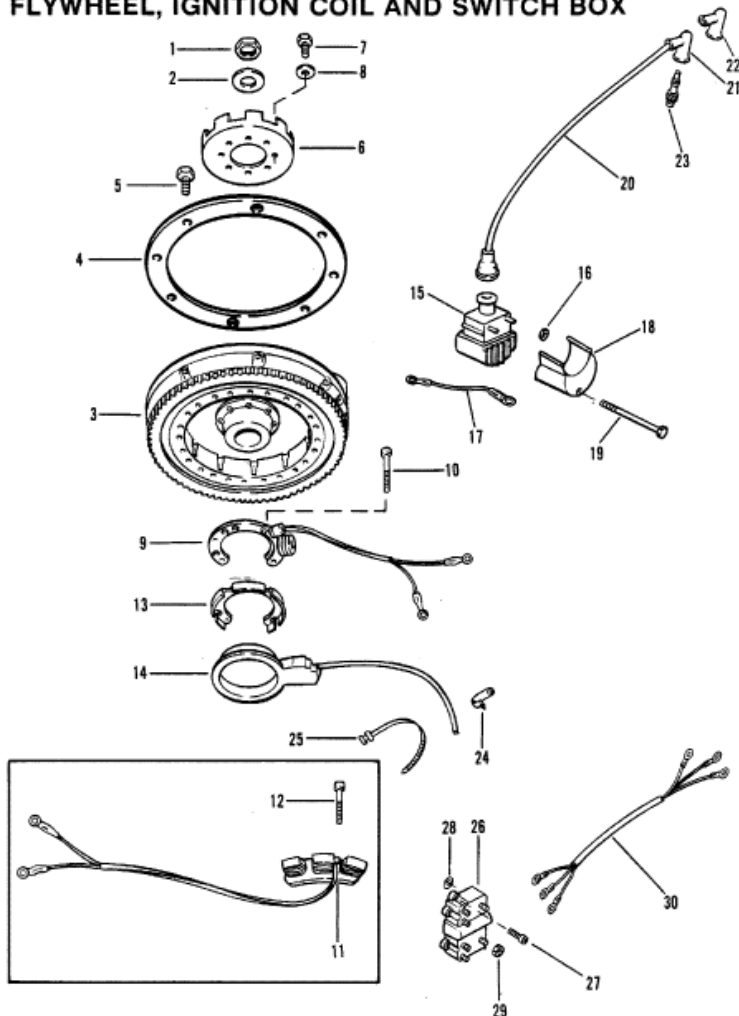

				Parts List			
Ref	Class	Part	Description	Qty	Comment	Footnote	
1	11	22339	NUT, FLYWHEEL	1			
2	12	68229	WASHER, FLYWHEEL NUT	1			
3	242	7912A14	FLYWHEEL ASSEMBLY (MANUAL)	1			
3	242	7912A12	FLYWHEEL ASSEMBLY (ELECTR)	1			
4		41409A 1	INERTIA RING ASSEMBLY	1			
5	10	32417	SCREW, FLYWHEEL (5/8")	8			
6	50	65213	RATCHET, FLYWHEEL MANUA	1			
7	10	68997	SCTREW, RATCHET TO FLYWI	8			
8	13	20202	LOCKWASHER, RATCHET SCR	2			
9		86617A11	STATOR (BOLT/NUT CONNECTC	1			
9		86617A13	STATOR (BULLET CONNECTOR	1			
10	10	77363	SCREW, STRATOR TO UPPER E	2			
10	10	76566	SCREW, STATOR TO UPPER EN	2			
11		86704A 2	STATOR ASSEMBLY, CHARGING	1			
12	10	93787	SCREW, STATOR TO UPPER EN	3	ELECTRIC		
13		95707	STRATOR SUPPORT	1			
14		92431A 1	TRIGGER PLATE (BOLT/NUT CO	1			
14		92431A 6	TRIGGER PLATE (BULLET CONN	1			
15	339	7370A13	IGNITION COIL ASSEMBLY	2			
16	11	45076	NUT, COIL TERMINAL	4			
17	84	60466A 8	GROUND WIRE, COIL COVER SC	2			
18		76254	COVER, IGNITION COIL	2			
19	10	69002	SCREW, COVER TO COIL BRACK	2			
19	10	93460	SCREW, COVER TO COIL BRACK	4			
20	84	99215A25	LEAD ASSEMBLY, SPARK PLUG	2			
21	85	63709A 1	PROTECTOR ASSEMBLY	2	FOR CANADA AND BELGIUM US		
22		99213	SHELL, SPARK PLUG BOOT	4			
23	33	97180	SPARK PLUG (NGH#BUHW)	2			
24	54	54457	"J" CLIP, LEAD WIRES	1			
25		61990	STA-STRAP	2			
26	339	7452A 3	SWITCH BOX (BOLT/NUT CONNE	1			
26	339	7452A 8	SWITCH BOX (BULLET CONNEC	1			
27	10	73484	SCREW, SWITCH BOX TO BRAC	3			
28	13	69432	LOCKWASHER, GROUND	1			
29	11	45076	NUT, SWITCH BOX TERMINAL	6			
30	84	94295A 1	HARNESS ASSEMBLY	1	PRIMARY (BOLT/NUT CONNEC		